











LEGEND:

-  SITE BOUNDARY
-  EXISTING TREE TO BE RETAINED (OUTSIDE APPLICATION SITE BOUNDARY)
-  PROPOSED HEAVY STANDARD TREE
-  PROPOSED LAWN
-  PROPOSED SHRUBS/GROUNDCOVER
-  PROPOSED GRASS PAVER
-  PROPOSED REEDBED
-  PROPOSED ISLANDS
-  WATER AREA
-  PROPOSED LEVEL
-  VERTICAL GREEN WALL (2.5m H) ON FENCE WALL REFER TO DWG NO.LD103
-  PARTITION WALL (5.0m H) (2.5m H SOLID WALL + 2.5m H WOODEN TRELLIS) REFER TO DWG NO.LD105
-  PARTITION WALL (2.5m H) (2.5m H WOODEN TRELLIS) REFER TO DWG NO.LD106
-  BOUNDARY OF WETLAND RESTORATION AREA (WRA)
-  PROPOSED PAVING
-  MAJOR VEHICULAR AND PEDESTRIAN ACCESS

-  **1 Main Entrance**
-  **2 Secondary Entrance**
-  **3 Club House**
-  **4 Footpath/EVA (Grass Pavers)**
-  **5 Roof Top Garden "A"**
-  **6 Roof Top Garden "B"**
-  **7 Sitting Courtyard "C"**
-  **8 Existing Fish Pond**

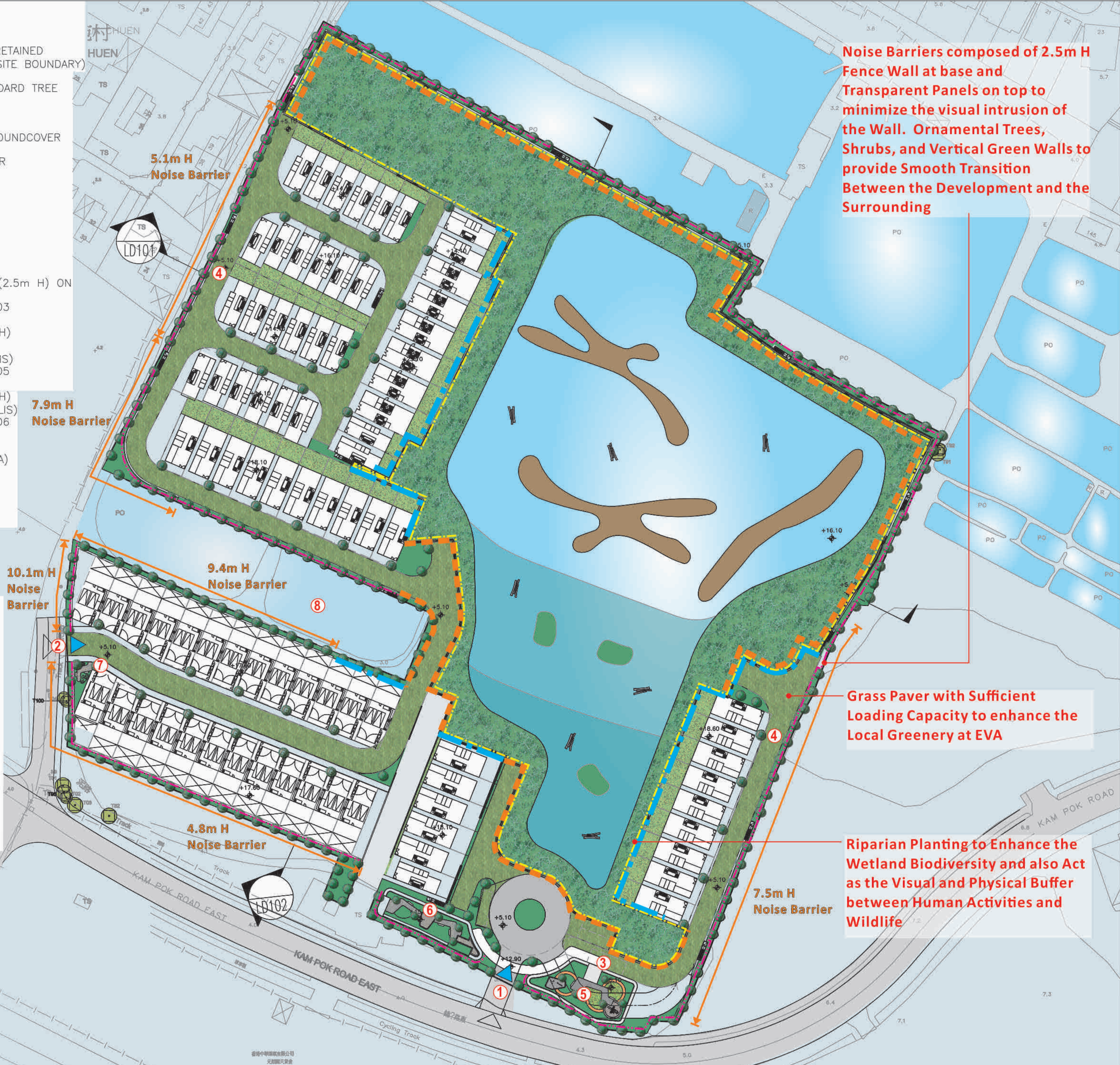

Noise Barriers composed of 2.5m H Fence Wall at base and Transparent Panels on top to minimize the visual intrusion of the Wall. Ornamental Trees, Shrubs, and Vertical Green Walls to provide Smooth Transition Between the Development and the Surrounding

Grass Paver with Sufficient Loading Capacity to enhance the Local Greenery at EVA

Riparian Planting to Enhance the Wetland Biodiversity and also Act as the Visual and Physical Buffer between Human Activities and Wildlife

PROJECT :
 PLANNING APPLICATION FOR PROPOSED COMPREHENSIVE DEVELOPMENT SCHEME TO INCLUDE WETLAND RESTORATION PROPOSED IN "OU(CDWRA)" ZONE AT NORTH OF KAM POK ROAD EAST, POK WAI, YUEN LONG, NEW TERRITORIES

DRAWING TITLE :
 LANDSCAPE MASTER PLAN (OVERALL)

PROJECT No. C1920

DRAWING No. LMP01

SCALE : 1:1200

DATE OF ISSUE : NOV 2022

CAD FILENAME : C1920-LMP01

REV	DESCRIPTION	DATE
DESIGN BY :	TEL	
DRAWN BY :	CAD	
CHECKED BY :	TEL	
APPROVED BY :	TEL	

NOTES :
 1. DO NOT SCALE DRAWING. FIGURED DIMENSIONS ARE TO BE FOLLOWED.
 2. COPYRIGHT OF THE DRAWING IS RETAINED BY THE AUTHORIZED PERSON.
 3. ALL DIMENSIONS ARE TO BE CHECKED AT SITE BY THE MAIN CONTRACTOR.
 4. READ THIS DWG. IN CONNECTION WITH GEN. ARCH. PLANS, STRUCT. PLANS, AND OTHER RELATED DWGS.

LanDes
 LANDES LIMITED
 景藝設計有限公司



KEY PLAN
SCALE 1:4000

- LEGEND:
- SITE BOUNDARY
 - EXISTING TREE TO BE RETAINED (OUTSIDE APPLICATION SITE BOUNDARY)
 - PROPOSED HEAVY STANDARD TREE
 - PROPOSED LAWN
 - PROPOSED SHRUBS/GROUNDCOVER
 - PROPOSED GRASS PAVER
 - PROPOSED REEDBED
 - PROPOSED ISLANDS
 - WATER AREA
 - PROPOSED LEVEL
 - VERTICAL GREEN WALL (2.5m H) ON FENCE WALL/NOISE BARRIERS REFER TO DWG NO.LD103
 - PARTITION WALL (5.0m H) (2.5m H SOLID WALL + 2.5m H WOODEN TRELLIS) REFER TO DWG NO.LD105
 - PARTITION WALL (2.5m H) (2.5m H WOODEN TRELLIS) REFER TO DWG NO.LD106
 - BOUNDARY OF WETLAND RESTORATION AREA (WRA)
 - PROPOSED PAVING
 - MAJOR VEHICULAR AND PEDESTRIAN ACCESS

- 1 Footpath/EVA (Grass Pavers)**
- 2 Wetland Restoration Area**
- 3 Existing Fish Pond**

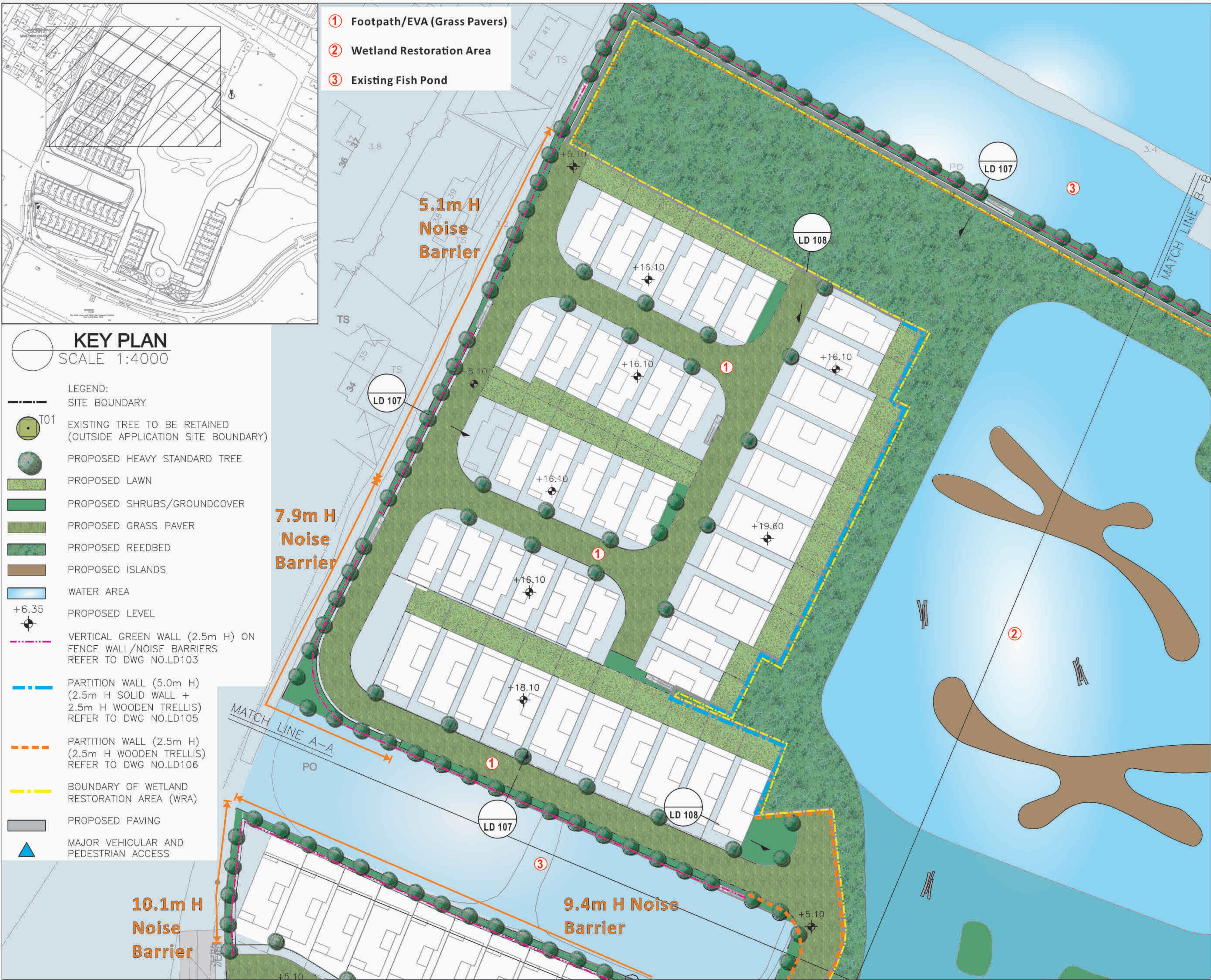

PROJECT :
PLANNING APPLICATION FOR PROPOSED COMPREHENSIVE DEVELOPMENT SCHEME TO INCLUDE WETLAND RESTORATION PROPOSED IN "OU(CDWRA)" ZONE AT NORTH OF KAM POK ROAD EAST, POK WAI, YUEN LONG, NEW TERRITORIES

DRAWING TITLE :
LANDSCAPE MASTER PLAN (SHEET 2 OF 5)

PROJECT No. C1920

DRAWING No. LMP02

SCALE : 1:700

DATE OF ISSUE : MAR 2020

CAD FILENAME : C1920-LMP02

REV	DESCRIPTION	DATE
DESIGN BY :	TEL	
DRAWN BY :	CAD	
CHECKED BY :	TEL	
APPROVED BY :	TEL	

- NOTES :
1. DO NOT SCALE DRAWING. FIGURED DIMENSIONS ARE TO BE FOLLOWED.
 2. COPYRIGHT OF THE DRAWING IS RETAINED BY THE AUTHORIZED PERSON.
 3. ALL DIMENSIONS ARE TO BE CHECKED AT SITE BY THE MAIN CONTRACTOR.
 4. READ THIS DWG. IN CONNECTION WITH GEN. ARCH. PLANS, STRUCT. PLANS, AND OTHER RELATED DWGS.

LanDes

LANDES LIMITED
景藝設計有限公司



- ① Footpath/EVA (Grass Pavers)
- ② Wetland Restoration Area
- ③ Existing Fish Pond

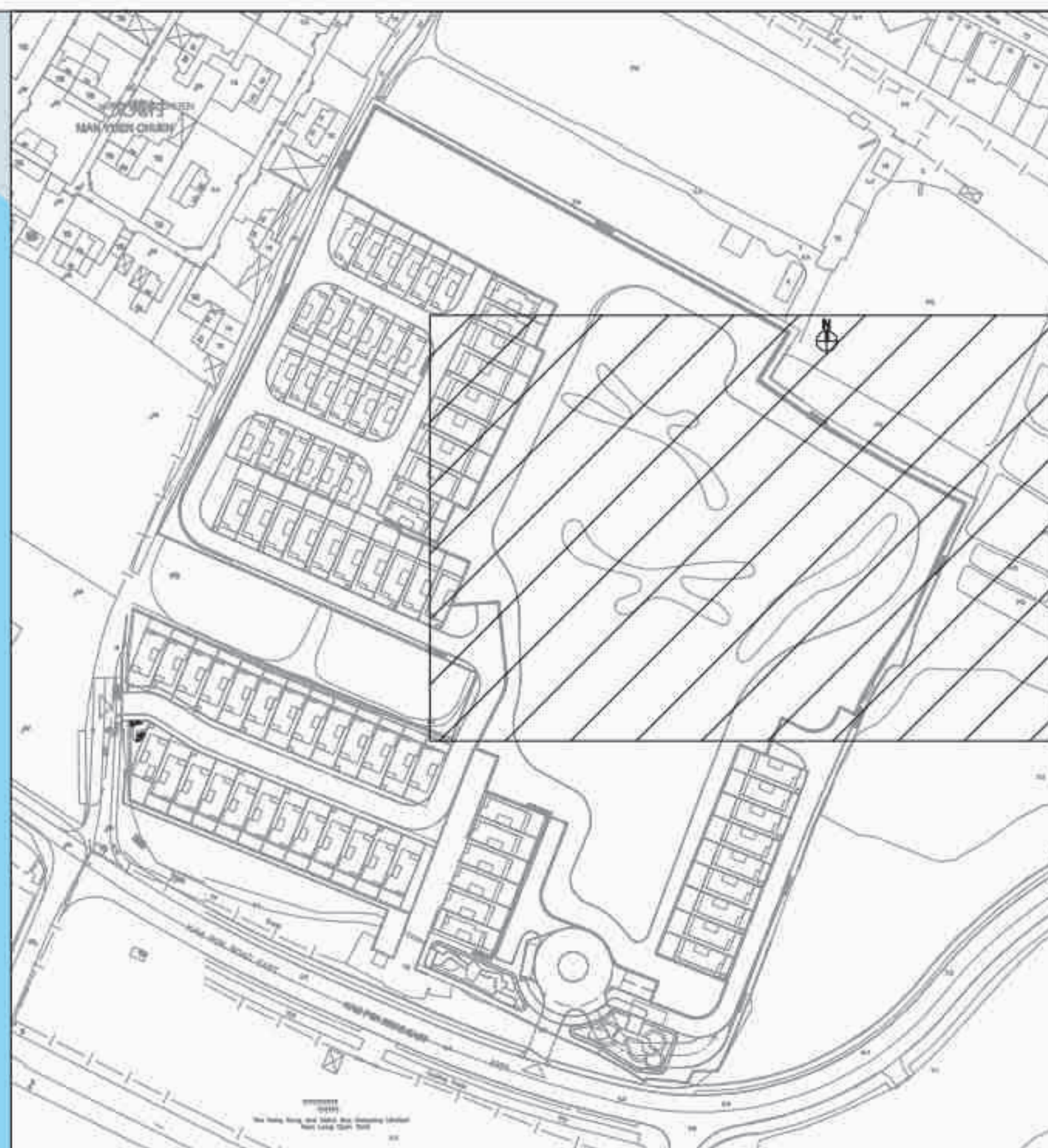

KEY PLAN
SCALE 1:4000

- LEGEND:
- SITE BOUNDARY
 - T01 EXISTING TREE TO BE RETAINED (OUTSIDE APPLICATION SITE BOUNDARY)
 - PROPOSED HEAVY STANDARD TREE
 - PROPOSED LAWN
 - PROPOSED SHRUBS/GROUNDCOVER
 - PROPOSED GRASS PAVER
 - PROPOSED REEDBED
 - PROPOSED ISLANDS
 - WATER AREA
 - +6.35 PROPOSED LEVEL
 - VERTICAL GREEN WALL (2.5m H) ON FENCE WALL/NOISE BARRIERS REFER TO DWG NO.LD103
 - PARTITION WALL (5.0m H) (2.5m H SOLID WALL + 2.5m H WOODEN TRELIS) REFER TO DWG NO.LD105
 - PARTITION WALL (2.5m H) (2.5m H WOODEN TRELIS) REFER TO DWG NO.LD106
 - BOUNDARY OF WETLAND RESTORATION AREA (WRA)
 - PROPOSED PAVING
 - ▲ MAJOR VEHICULAR AND PEDESTRIAN ACCESS

PROJECT :
PLANNING APPLICATION FOR PROPOSED COMPREHENSIVE DEVELOPMENT SCHEME TO INCLUDE WETLAND RESTORATION PROPOSED IN "OU(CDWRA)" ZONE AT NORTH OF KAM POK ROAD EAST, POK WAI, YUEN LONG, NEW TERRITORIES

DRAWING TITLE :
LANDSCAPE MASTER PLAN (SHEET 3 OF 5)

PROJECT No. C1920

DRAWING No. LMP03

SCALE : 1:700

DATE OF ISSUE : MAR 2020

CAD FILENAME : C1920-LMP03

REV	DESCRIPTION	DATE
DESIGN BY :	TEL	
DRAWN BY :	CAD	
CHECKED BY :	TEL	
APPROVED BY :	TEL	

- NOTES :
1. DO NOT SCALE DRAWING. FIGURED DIMENSIONS ARE TO BE FOLLOWED.
 2. COPYRIGHT OF THE DRAWING IS RETAINED BY THE AUTHORIZED PERSON.
 3. ALL DIMENSIONS ARE TO BE CHECKED AT SITE BY THE MAIN CONTRACTOR.
 4. READ THIS DWG. IN CONNECTION WITH GEN. ARCH. PLANS, STRUCT. PLANS, AND OTHER RELATED DWGS.

LanDes
LANDES LIMITED
景藝設計有限公司

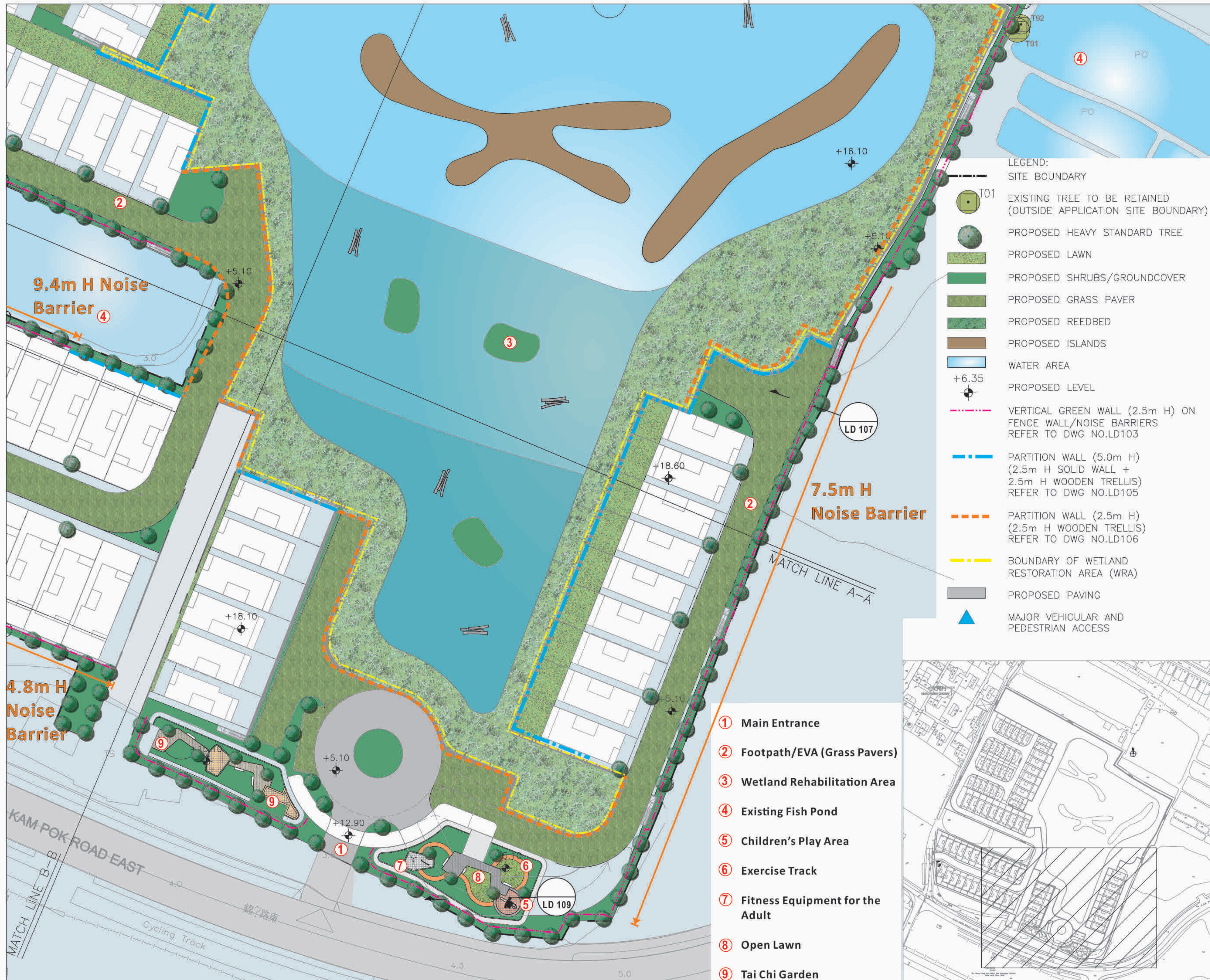

PROJECT :
 PLANNING APPLICATION FOR PROPOSED COMPREHENSIVE DEVELOPMENT SCHEME TO INCLUDE WETLAND RESTORATION PROPOSED IN "OU(CDWRA)" ZONE AT NORTH OF KAM POK ROAD EAST, POK WAI, YUEN LONG, NEW TERRITORIES

DRAWING TITLE :
 LANDSCAPE MASTER PLAN (SHEET 4 OF 5)

PROJECT No. C1920

DRAWING No. LMP04

SCALE : 1:700

DATE OF ISSUE : MAR 2020

CAD FILENAME : C1920-LMP04

- LEGEND:
- SITE BOUNDARY
 - T01 EXISTING TREE TO BE RETAINED (OUTSIDE APPLICATION SITE BOUNDARY)
 - PROPOSED HEAVY STANDARD TREE
 - PROPOSED LAWN
 - PROPOSED SHRUBS/GROUNDCOVER
 - PROPOSED GRASS PAVER
 - PROPOSED REEDBED
 - PROPOSED ISLANDS
 - WATER AREA
 - +6.35 PROPOSED LEVEL
 - VERTICAL GREEN WALL (2.5m H) ON FENCE WALL/NOISE BARRIERS REFER TO DWG NO.LD103
 - PARTITION WALL (5.0m H) (2.5m H SOLID WALL + 2.5m H WOODEN TRELLIS) REFER TO DWG NO.LD105
 - PARTITION WALL (2.5m H) (2.5m H WOODEN TRELLIS) REFER TO DWG NO.LD106
 - BOUNDARY OF WETLAND RESTORATION AREA (WRA)
 - PROPOSED PAVING
 - ▲ MAJOR VEHICULAR AND PEDESTRIAN ACCESS

- ① Main Entrance
- ② Footpath/EVA (Grass Pavers)
- ③ Wetland Rehabilitation Area
- ④ Existing Fish Pond
- ⑤ Children's Play Area
- ⑥ Exercise Track
- ⑦ Fitness Equipment for the Adult
- ⑧ Open Lawn
- ⑨ Tai Chi Garden

REV	DESCRIPTION	DATE
DESIGN BY :	TEL	
DRAWN BY :	CAD	
CHECKED BY :	TEL	
APPROVED BY :	TEL	

NOTES :

- DO NOT SCALE DRAWING. FIGURED DIMENSIONS ARE TO BE FOLLOWED.
- COPYRIGHT OF THE DRAWING IS RETAINED BY THE AUTHORIZED PERSON.
- ALL DIMENSIONS ARE TO BE CHECKED AT SITE BY THE MAIN CONTRACTOR.
- READ THIS DWG. IN CONNECTION WITH GEN. ARCH. PLANS, STRUCT. PLANS, AND OTHER RELATED DWGS.

LanDes
 LANDES LIMITED
 景藝設計有限公司





KEY PLAN
SCALE 1:4000

- LEGEND:**
- SITE BOUNDARY
 - EXISTING TREE TO BE RETAINED (OUTSIDE APPLICATION SITE BOUNDARY)
 - PROPOSED HEAVY STANDARD TREE
 - PROPOSED LAWN
 - PROPOSED SHRUBS/GROUND COVER
 - PROPOSED GRASS PAVER
 - PROPOSED REEDBED
 - PROPOSED ISLANDS
 - WATER AREA
 - PROPOSED LEVEL
 - VERTICAL GREEN WALL (2.5m H) ON FENCE WALL/NOISE BARRIERS REFER TO DWG NO.LD103
 - PARTITION WALL (5.0m H) (2.5m H SOLID WALL + 2.5m H WOODEN TRELLIS) REFER TO DWG NO.LD105
 - PARTITION WALL (2.5m H) (2.5m H WOODEN TRELLIS) REFER TO DWG NO.LD106
 - BOUNDARY OF WETLAND RESTORATION AREA (WRA)
 - PROPOSED PAVING
 - MAJOR VEHICULAR AND PEDESTRIAN ACCESS



- ① Main Entrance**
- ② Secondary Entrance**
- ③ Footpath/EVA (Grass Pavers)**
- ④ Wetland Rehabilitation Area**
- ⑤ Existing Fish Pond**
- ⑥ Tai Chi Garden**
- ⑦ Fitness Equipment for the Adult**
- ⑧ Exercise Track**
- ⑨ Open Lawn**
- ⑩ Sitting Bench**
- ⑪ Earth Berm with Ornamental Plant**

PROJECT :
PLANNING APPLICATION FOR PROPOSED COMPREHENSIVE DEVELOPMENT SCHEME TO INCLUDE WETLAND RESTORATION PROPOSED IN "OU(CDWRA)" ZONE AT NORTH OF KAM POK ROAD EAST, POK WAI, YUEN LONG, NEW TERRITORIES

DRAWING TITLE :
LANDSCAPE MASTER PLAN (SHEET 5 OF 5)

PROJECT No. C1920

DRAWING No. LMP05

SCALE : 1:700

DATE OF ISSUE : MAR 2020

CAD FILENAME : C1920-LMP05

REV	DESCRIPTION	DATE
DESIGN BY :	TEL	
DRAWN BY :	CAD	
CHECKED BY :	TEL	
APPROVED BY :	TEL	

- NOTES :**
1. DO NOT SCALE DRAWING. FIGURED DIMENSIONS ARE TO BE FOLLOWED.
 2. COPYRIGHT OF THE DRAWING IS RETAINED BY THE AUTHORIZED PERSON.
 3. ALL DIMENSIONS ARE TO BE CHECKED AT SITE BY THE MAIN CONTRACTOR.
 4. READ THIS DWG. IN CONNECTION WITH GEN. ARCH. PLANS, STRUCT. PLANS, AND OTHER RELATED DWGS.

LanDes

LANDES LIMITED
景藝設計有限公司